

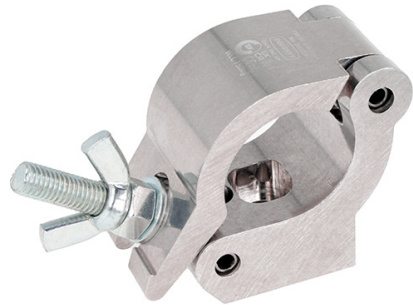

Side Entry Clamps



Product Data Sheet



A 50mm Half Coupler designed with side entry.
Ideal for cross bracing of if height above the barrel is limited

Part Nos	T58780 - Polished T58782 - Powder Painted Satin Black
Tube Diameter	Ø48 - 51mm
Materials	Main Body - AW6082 T6 Aluminium Roll Pins - Stainless Steel Eyebolt Assy - Grade 8.8
Max Tightening Torque	30Nm
Fixings	M12
WLL	750Kg
Weight	0.54Kg
Factor of Safety	5:1
Approval	TÜV Approved

Dimensions in mm

