

Spare parts list

21430 Overhead microphone stand

21430-500-55 - black

*Rev 04

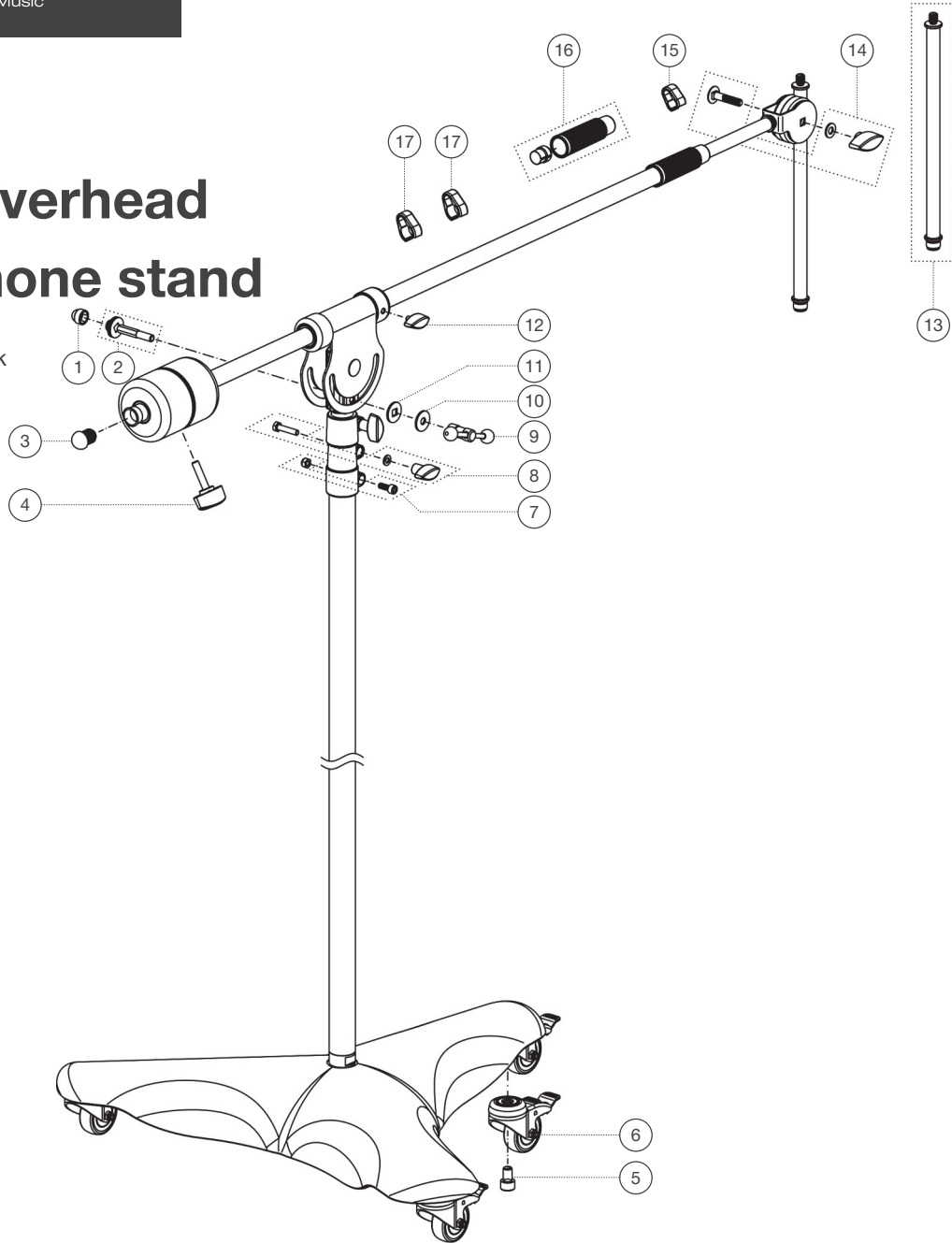

| Position | Description | Article No. | Quantity |
|----------|--|------------------------------|----------|
| 1 | Protective cap | 03-20-415-55 | 2 |
| 2 | Hexagon threaded bolt with washers and nut | 6-21430-3-00 | 1 |
| 3 | Cover plug ø 21 mm | 03-20-938-55 | 1 |
| 4 | Clamping screw M8 x 33 mm | 01-83-832-55 | 1 |
| 5 | Cylinder head screw M10 x 16 mm | 03-02-416-40 | 3 |
| 6 | Lockable castor wheels | 03-25-130-00 | 3 |
| 7 | Screw connection | 3-00-000-157 | 1 |
| 8 | Screw connection | 3-00-000-068 | 1 |
| 9 | T-bar locking screw | 6-30351-1-55 | 1 |
| 10 | Washer ø 8.4 mm | 03-11-525-25 | 1 |
| 11 | Washer with square hole | 01-86-956-55 | 1 |
| 12 | Clamping screw M6 x 12 mm | 01-83-040-55 | 1 |
| 13 | Mini boom arm with connecting thread | 6-21430-2-55 | 1 |
| 14 | Screw connection | 3-00-000-090 | 1 |
| 15 | Cable holder ø 15 mm | 01-85-960-55 | 1 |
| 16 | Clutch with tension ring | 3-00-000-037 | 1 |
| 17 | Cable holder ø 20 mm | 01-85-970-55 | 2 |